

# AMADEA

SEALED BID AUCTION  
SEPTEMBER 10, 2025



*Forfeited by order of the United States District Court  
Southern District of New York, Case 1:23-cv-09304*

**AmadeaAuction.com**



AMADEA

Built to the highest standards at the renowned Lürssen shipyard, the 106.1m superyacht AMADEA delivers a truly one-of-a-kind experience.

Fully compliant with the Passenger Yacht Code (PYC 12-36 pax), AMADEA accommodates up to 22 guests while cruising and offers luxurious overnight accommodations for 16 guests across 8 staterooms.

AMADEA represents a unique offering in the 100m+ category—built to deliver a rare degree of privacy, permanence, and versatility. Built by Lürssen to Lloyd’s standards, with a steel hull, aluminum superstructure, and over 4,402 Gross Tons of internal volume for unmatched space, stability and scale. Espin Øino’s powerful profile balances seamlessly with Zuretti’s lavish, high-touch interior spaces. A dedicated Owner’s deck designed for privacy is fitted every appointment imaginable. Amadea has world-cruising autonomy with over 8,000 nautical miles of range and full helideck means AMADEA is built to roam far beyond the typical seasonal ports. Never commercially chartered or heavily used, AMADEA is ready for many years of global cruising.

|               |   |
|---------------|---|
| BUILDER       | LÜRSSEN   |
| BUILT         | 2017  |
| L.O.A.        | 106.10m (348'01")                               |
| BEAM          | 18.30m (60'00")                                 |
| STATEROOMS    | 8 staterooms accommodating 16 guests            |
| GUESTS        | 22 while cruising (PYC compliant), 16 overnight |
| CREW          | 36 crew in 21 cabins                            |
| RANGE : SPEED | 8,000nm range at 13kn cruising                  |
| HULL MATERIAL | Steel   |
| FLAG          | USA (Previously CISR)                           |

KEY FEATURES

- Appealing design by Espen Øino
- Highly detailed luxury interior executed by Francois Zuretti
- PYC compliant: up to 22 guests on board
- Eight stateroom configurations, plus a convertible meeting room located on the lower deck
- Private owner’s deck featuring a forward-facing master cabin, outdoor Jacuzzi, dressing room, beauty salon, office, gym, living and dining area, bar, and a spacious skylounge
- Guest spa equipped with a sauna, hammam, chromotherapy dip pool, massage room, and a relaxation room with a sea terrace that opens directly to the ocean
- 10-meter infinity pool
- Private cinema with D-Box motion seating, located near the spa area
- Six decks in total, with five dedicated exclusively to guest use
- Two elevators servicing all decks – one for guests, one for crew and service operations
- Three tenders - a 10.97m limousine tender, a 10.97m sports tender, and an 8.8m beach landing tender
- Helipad designed to accommodate a Eurocopter EC135 or similar aircraft
- Dynamic Positioning System for enhanced stability and precision at anchor
- 4,402 gross tons of internal volume
- 8,000-nautical mile range at a cruising speed of 13 knots

Yachts offered are subject to availability. The particulars are believed to be correct but are not guaranteed and may not be used for contractual purposes. Specification provided for information only.











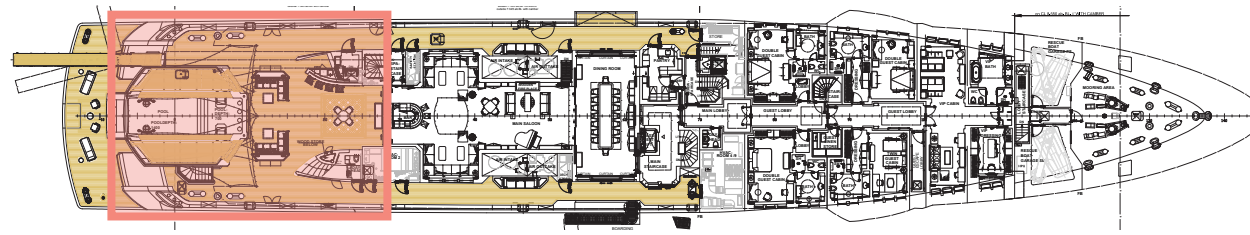

POOL LOOKING AFT



POOL LOOKING AFT TO PORT



POOL LOOKING AFT TO STARBOARD





LOOKING FORWARD



LOOKING FORWARD TO PORT



PORT SIDE



LOOKING TO STARBOARD



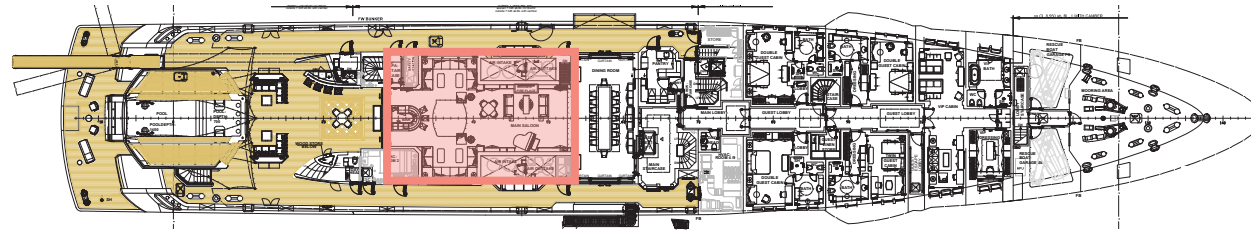

LOOKING FORWARD





BAR LOOKING AFT



LOOKING AFT TO PORT



LOOKING FORWARD TO PORT



LOOKING FORWARD TO STARBOARD







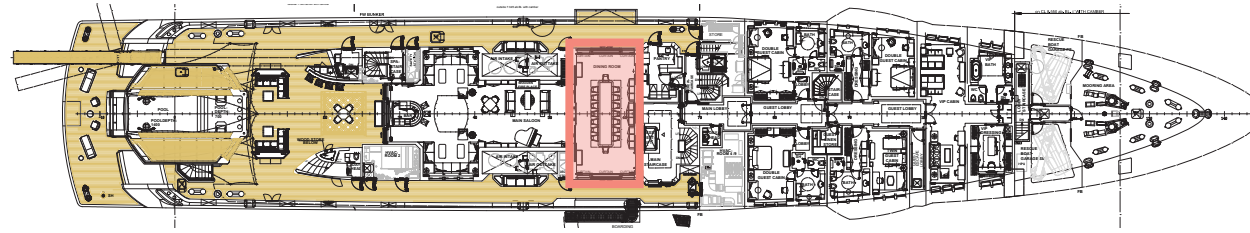

LOOKING FORWARD



LOOKING AFT TO PORT



LOOKING AFT TO PORT



LOOKING AFT TO STARBOARD



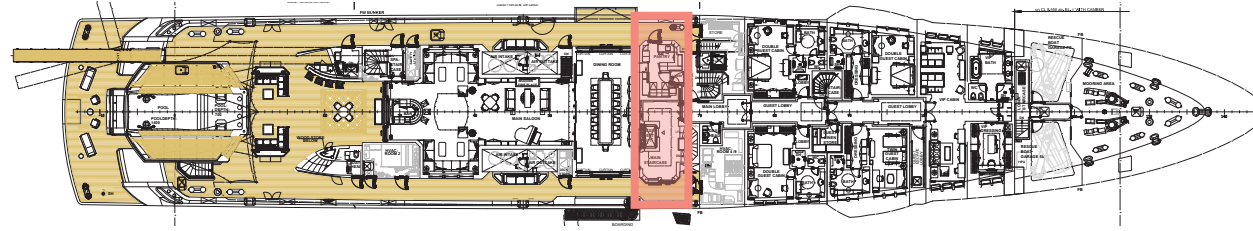

ELEVATOR & FOYER LOOKING FORWARD TO STARBOARD



DAY HEAD STARBOARD SIDE



PANTRY PORT SIDE



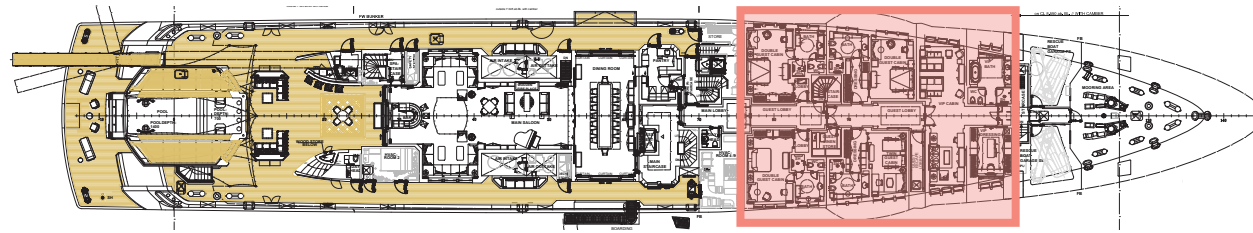

GUEST LOBBY



















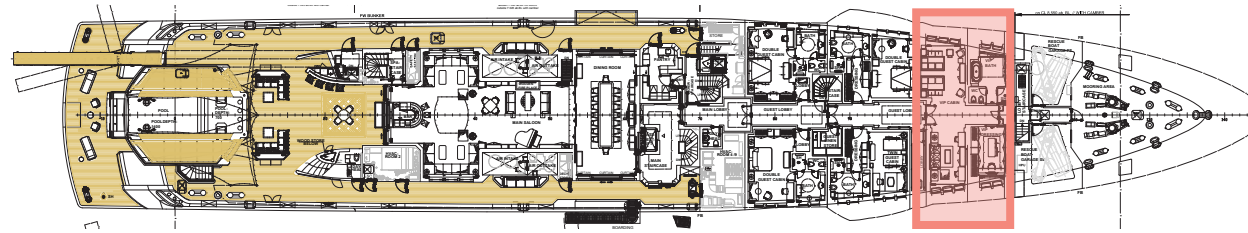







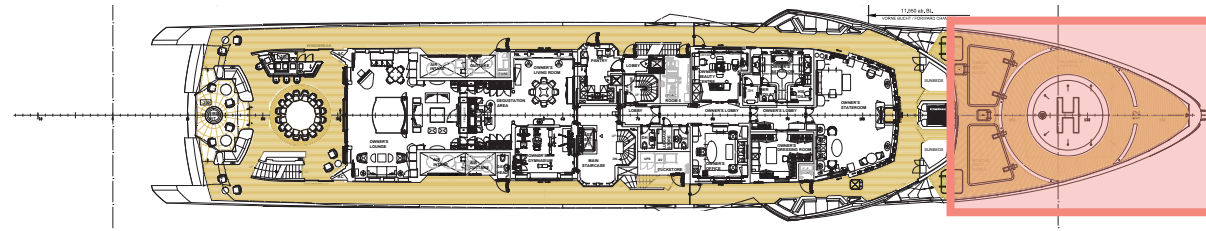







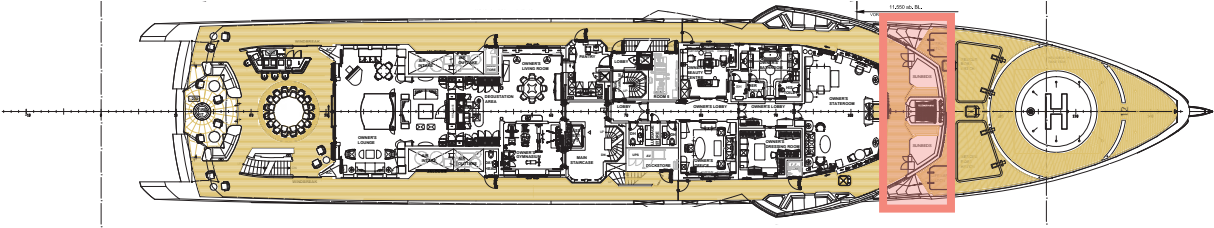

JACUZZI LOOKING AFT



JACUZZI LOOKING FORWARD



SUNPADS FORWARD



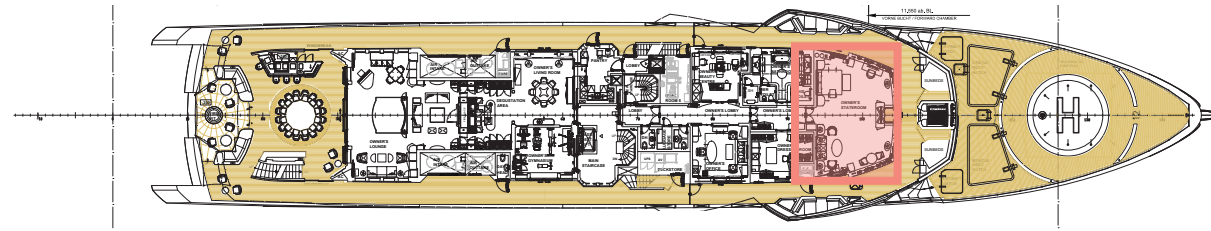









LOOKING FORWARD



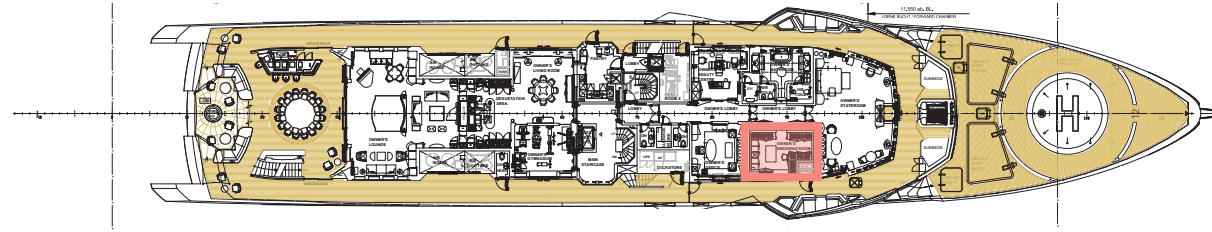



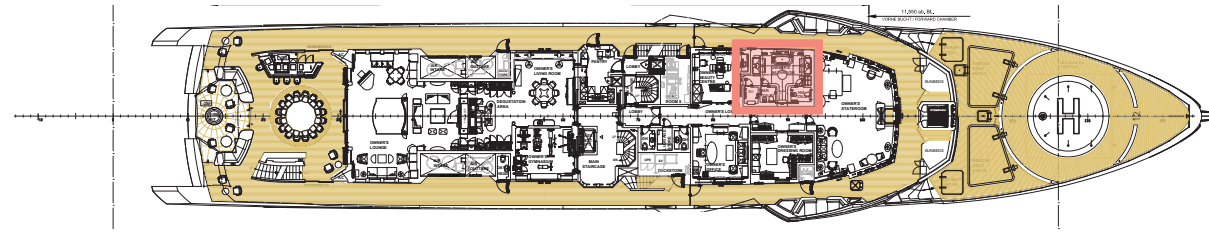



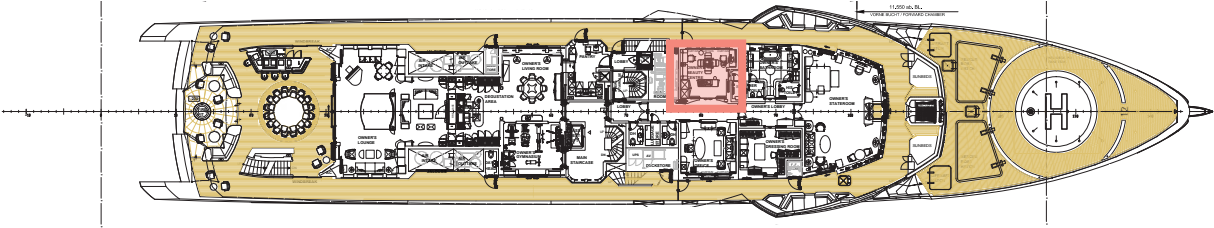

LOOKING TO STARBOARD



LOOKING FORWARD



LOOKING AFT



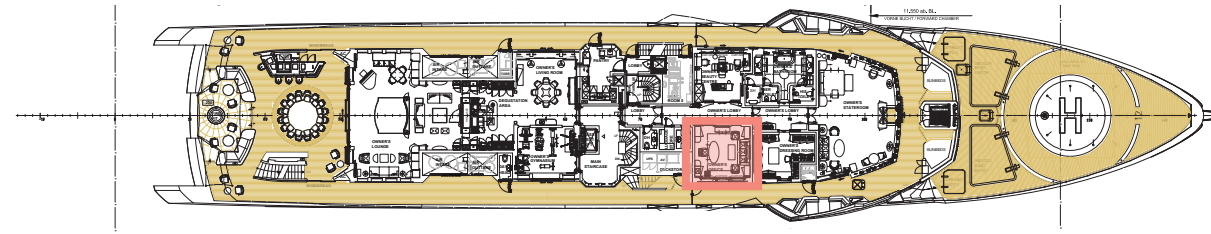

LOOKING FORWARD TO STARBOARD



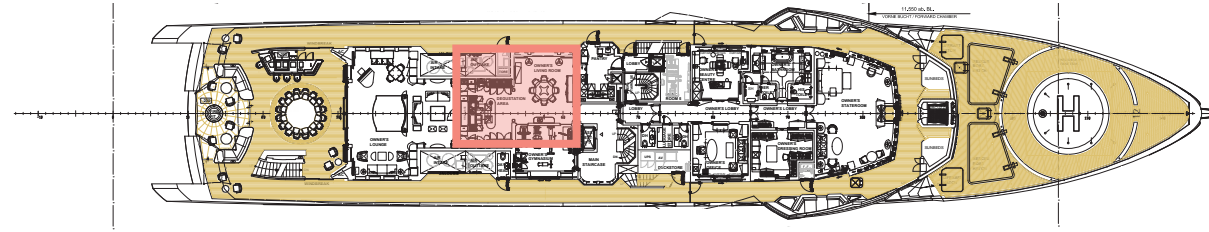

LOOKING FORWARD TO PORT



LOOKING AFT TO PORT



BAR LOOKING AFT



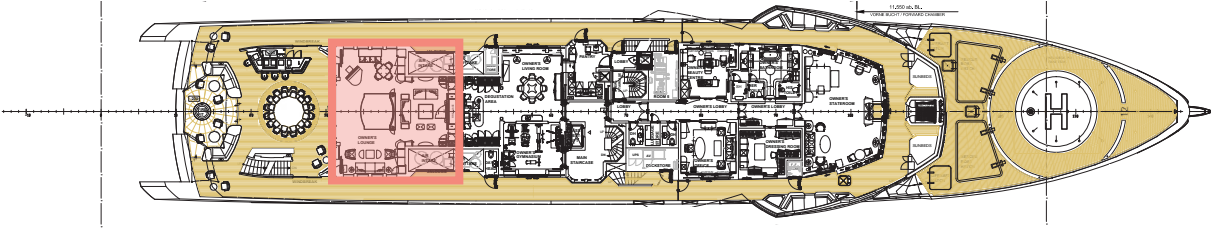

LOOKING AFT TO PORT



LOOKING FORWARD TO PORT



LOOKING FORWARD TO STARBOARD







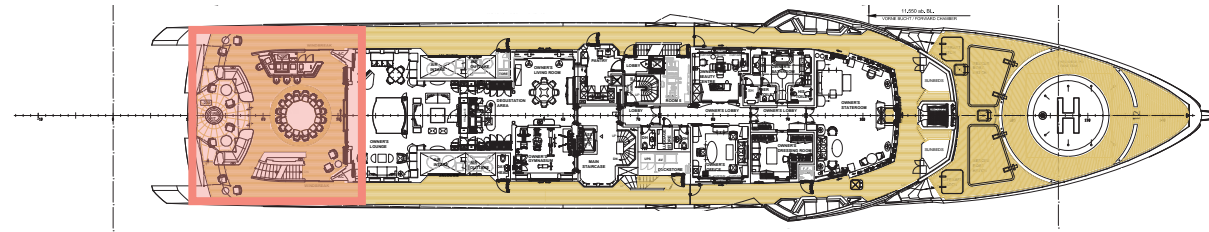

LOOKING FORWARD





LOOKING AFT



LOOKING AFT TO PORT



LOOKING FORWARD TO STARBOARD



LOOKING AFT TO PORT



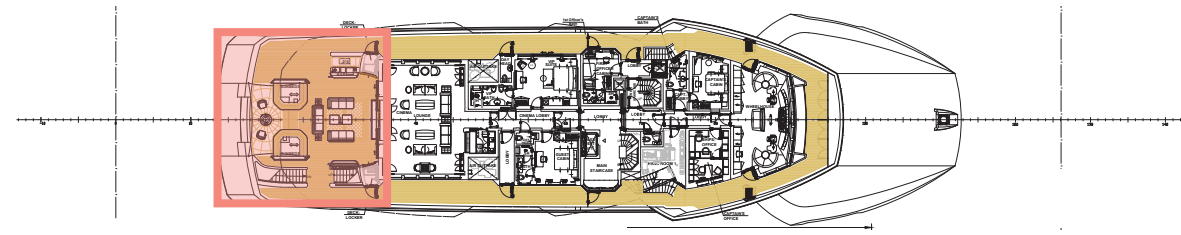













LOOKING AFT



LOOKING FORWARD TO PORT



LOOKING FORWARD TO STARBOARD



LOOKING AFT TO STARBOARD



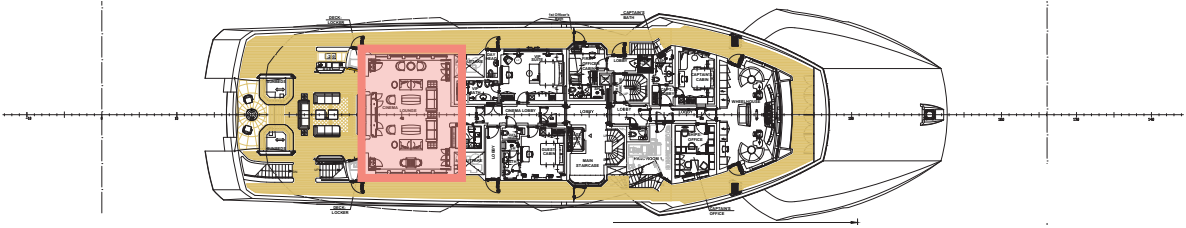

LOOKING AFT



LOUNGE BAR OPEN



LOUNGE BAR CLOSED







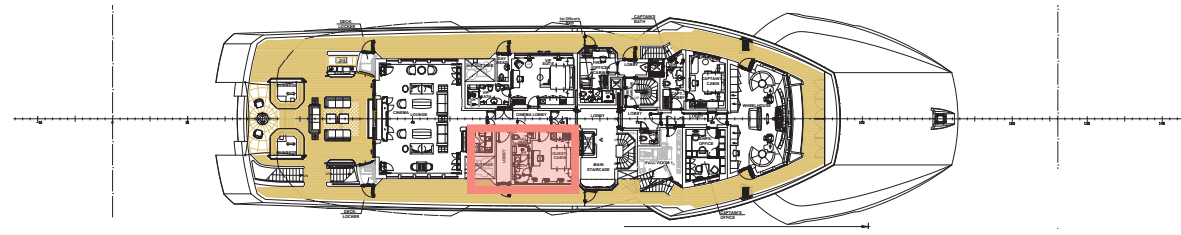

LOOKING FORWARD OUTBOARD



LOOKING INBOARD



HEAD



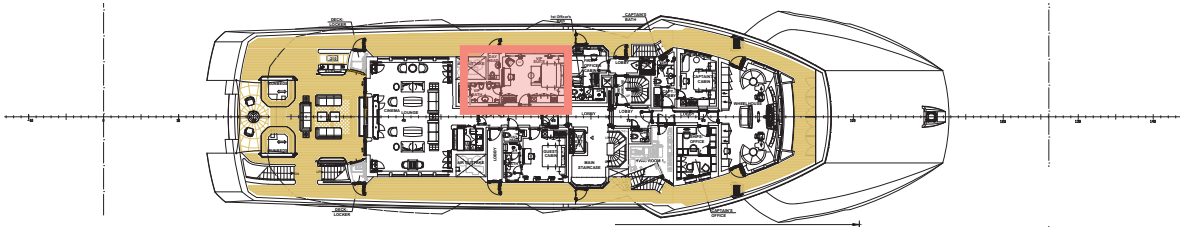

LOOKING TO PORT OUTBOARD



LOOKING AFT TO INBOARD



HEAD



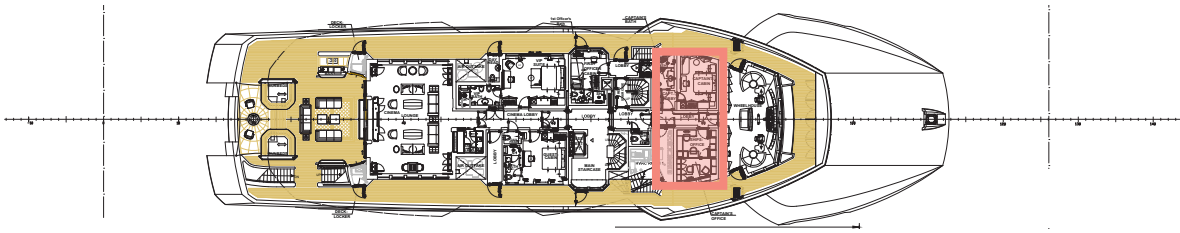

CAPTAIN'S CABIN PORT SIDE



CAPTAIN'S HEAD PORT SIDE



SHIP'S OFFICE STARBOARD SIDE



CAPTAIN'S OFFICE STARBOARD SIDE



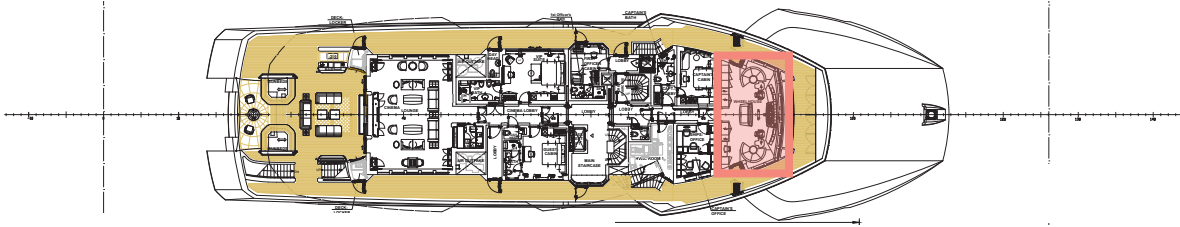

LOOKING FORWARD TO STARBOARD



LOOKING TO PORT



SEATING AREA



DESK



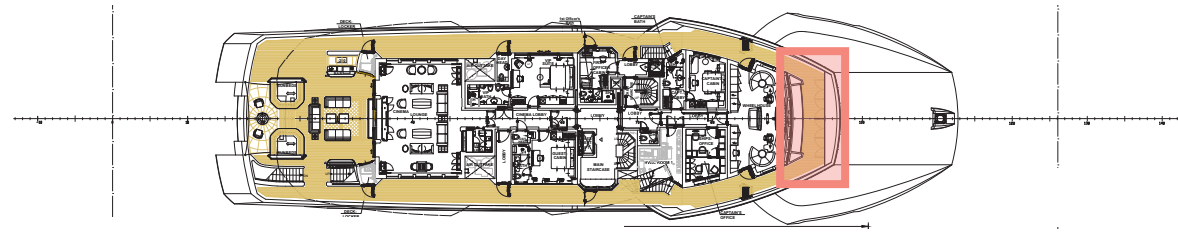



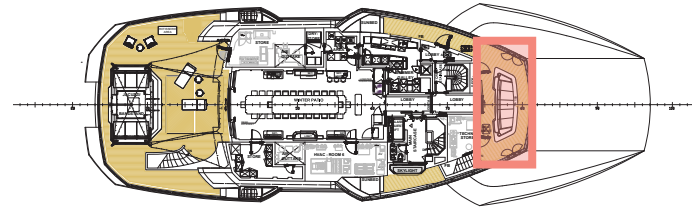



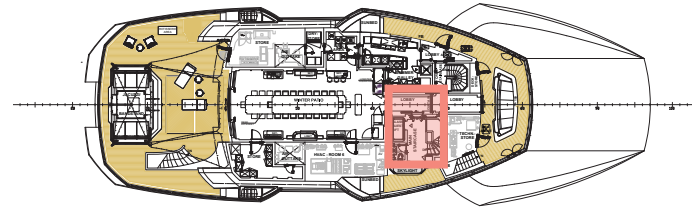

LOBBY LOOKING FORWARD



LOOKING TO STARBOARD



MAIN STAIRCASE



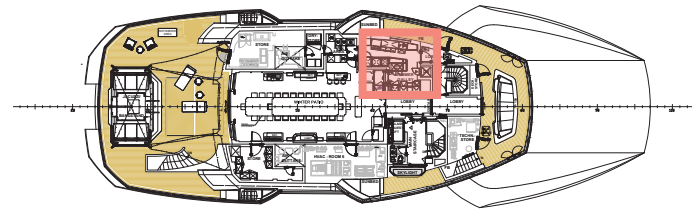

LOOKING FORWARD



LOOKING AFT



LOOKING FORWARD



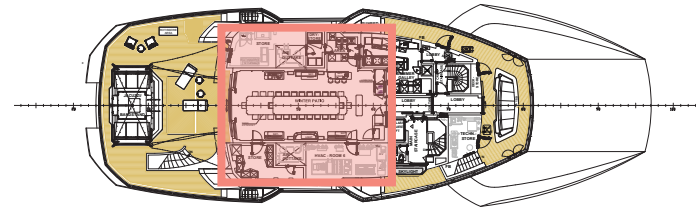

LOOKING FORWARD TO PORT

LOOKING AFT



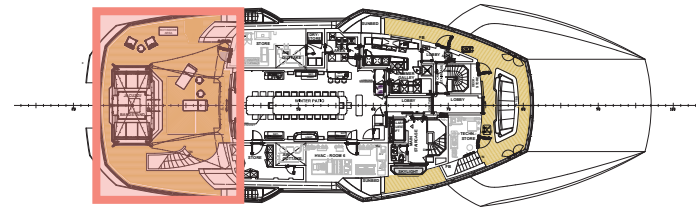





LOOKING AFT



STARBOARD SIDE



LOOKING FORWARD TO PORT



JACUZZI LOOKING FORWARD



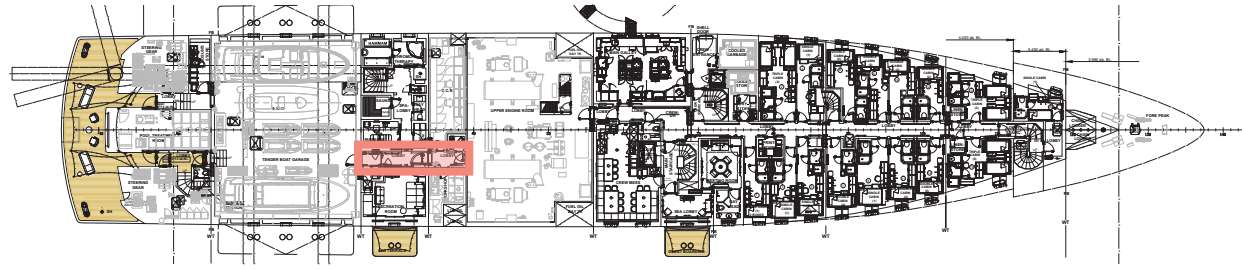



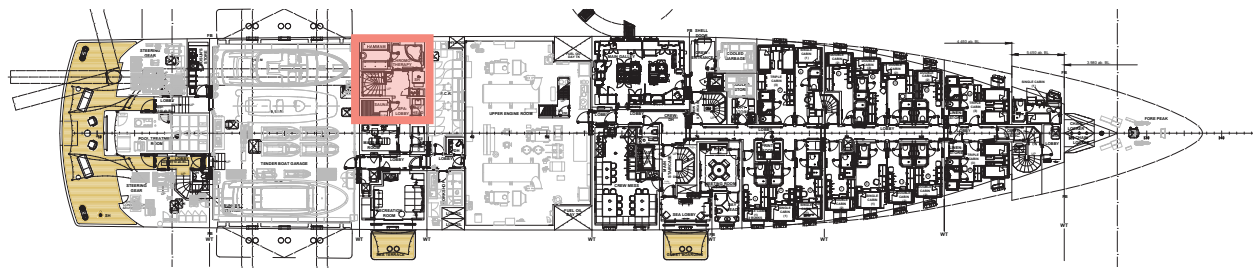

SPA LOBBY



SPA LOBBY



SPA LOBBY



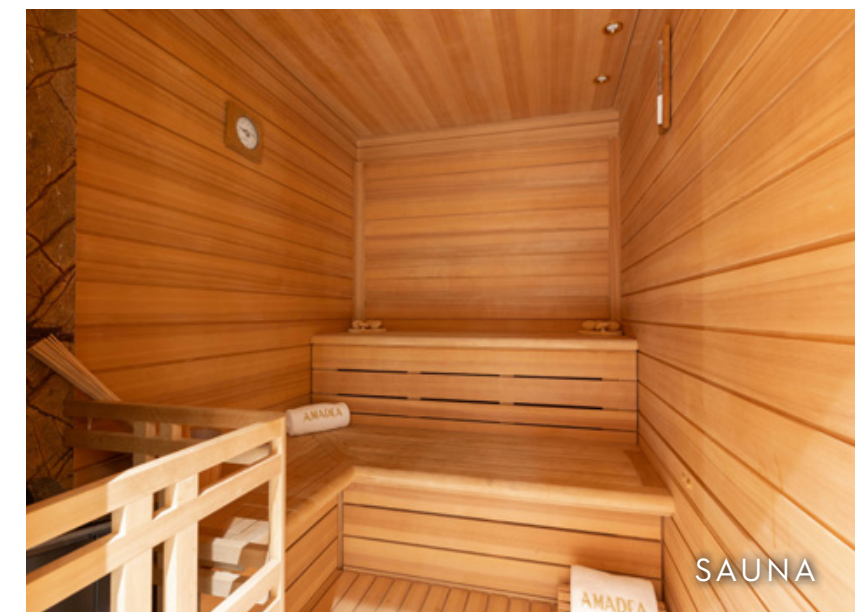



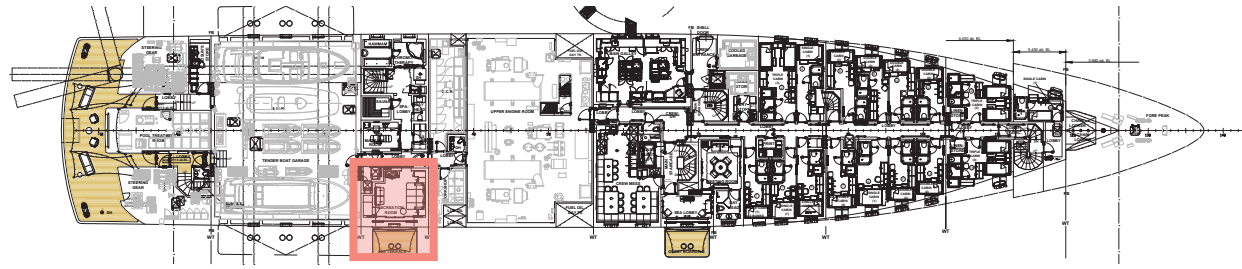

LOOKING INBOARD



LOOKING OUTBOARD



LOOKING AFT



LOOKING FORWARD



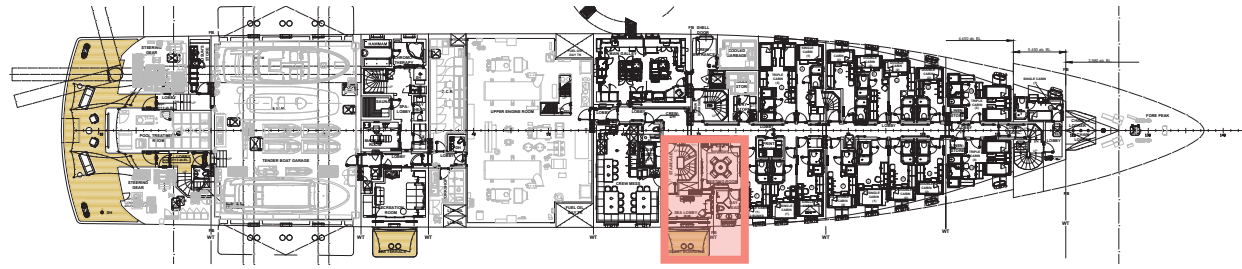

SEA LOBBY LOOKING OUTBOARD



SEA LOBBY LOOKING INBOARD



MEETING ROOM



MEETING ROOM CONVERTIBLE



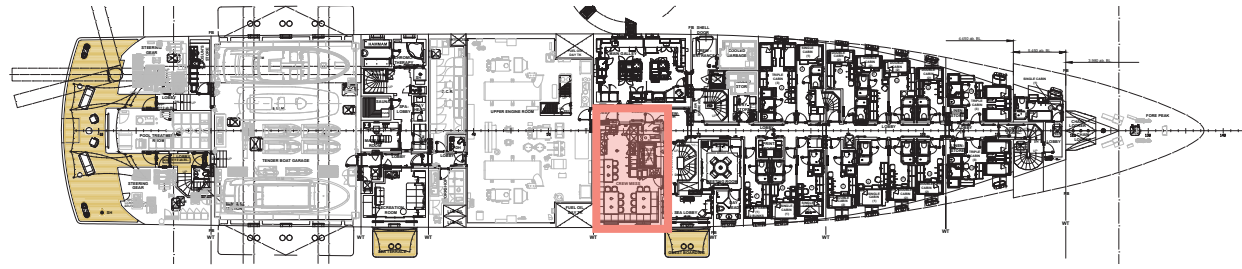



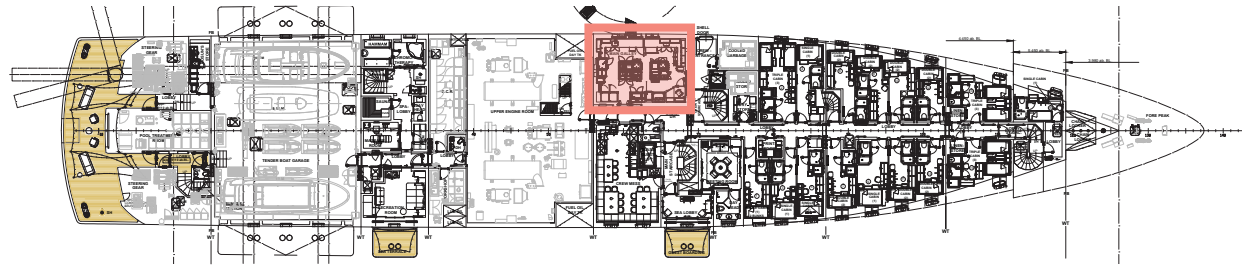

GALLEY



GALLEY



CHEF'S OFFICE



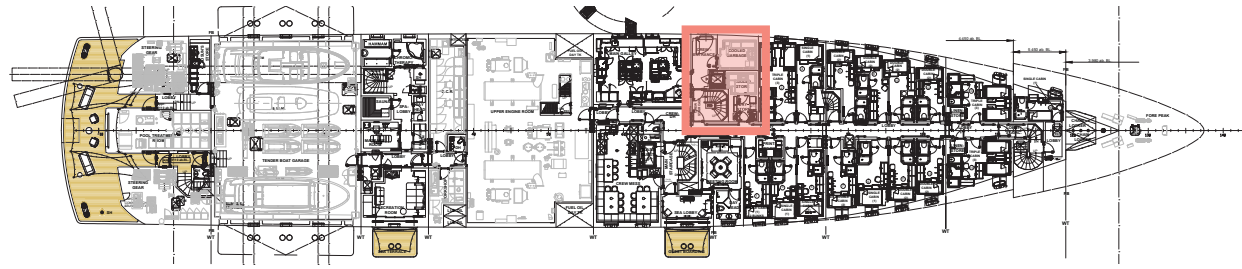

CREW ELEVATOR



DRY STORAGE



COOLED STORAGE



COOLED GARBAGE



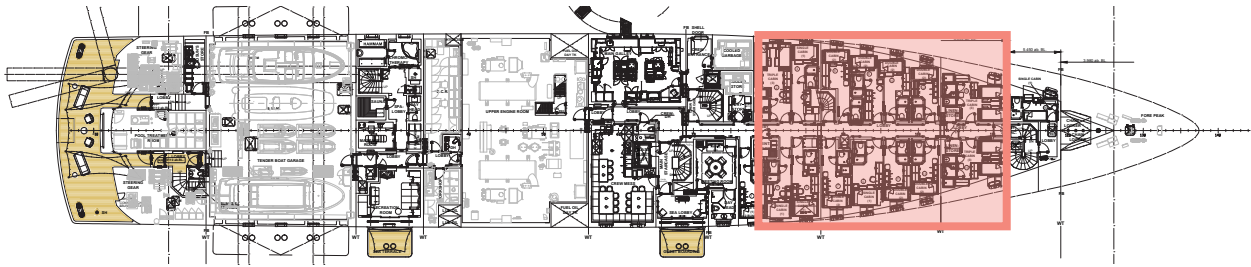

TRIPLE CABIN



TRIPLE CABIN



TRIPLE CABIN



TRIPLE CABIN





DOUBLE CABIN



DOUBLE CABIN



DOUBLE CABIN





SINGLE CABIN



SINGLE CABIN



SINGLE CABIN



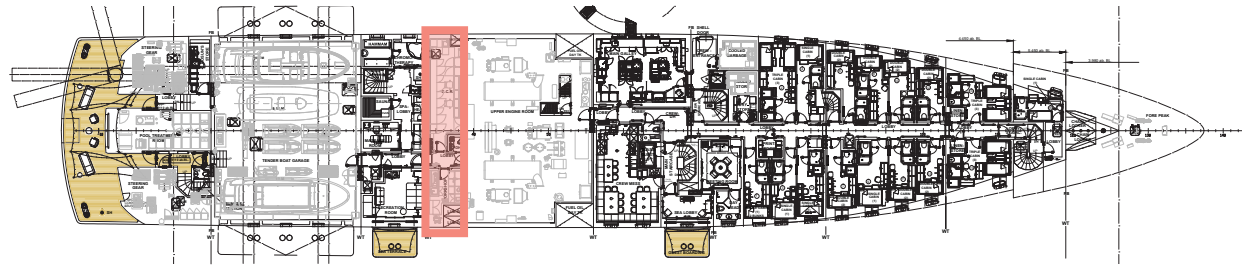

ENGINE CONTROL ROOM



ENGINE CONTROL ROOM



WORKSHOP



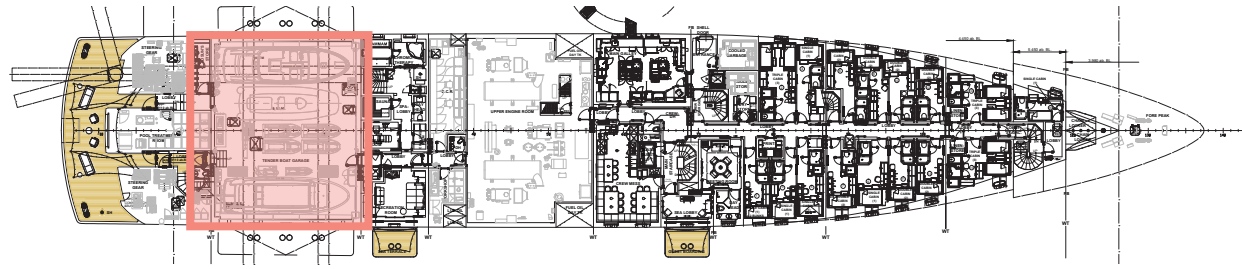







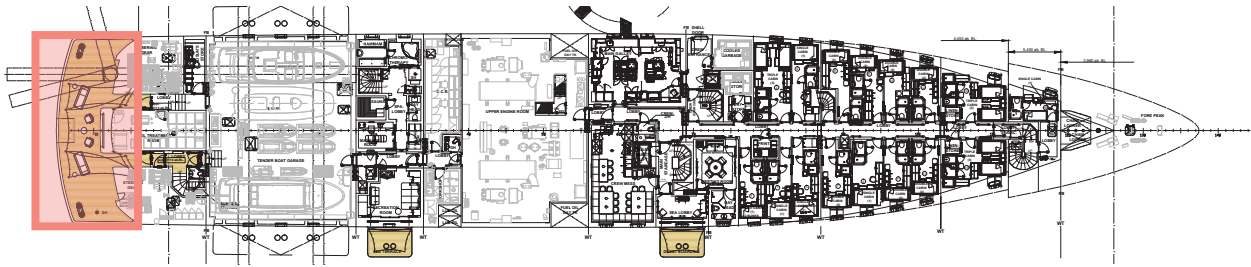

STERN



SWIM PLATFORM



SWIM PLATFORM



SWIM PLATFORM



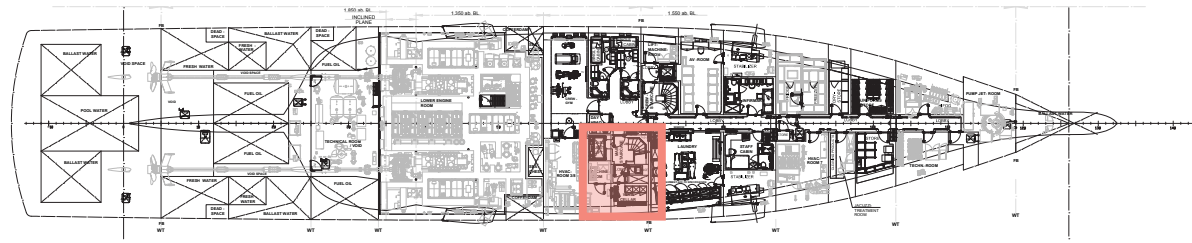

FOYER TO WINE CELLAR AND HUMIDOR



WINE CELLAR



WINE CELLAR

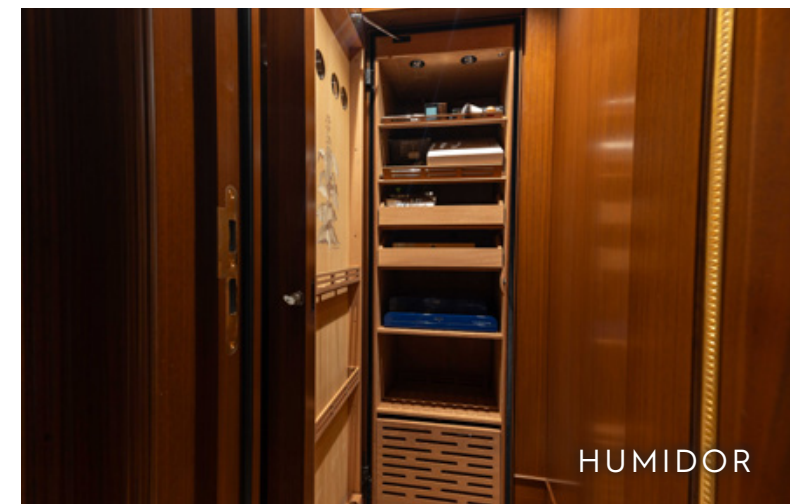

HUMIDOR



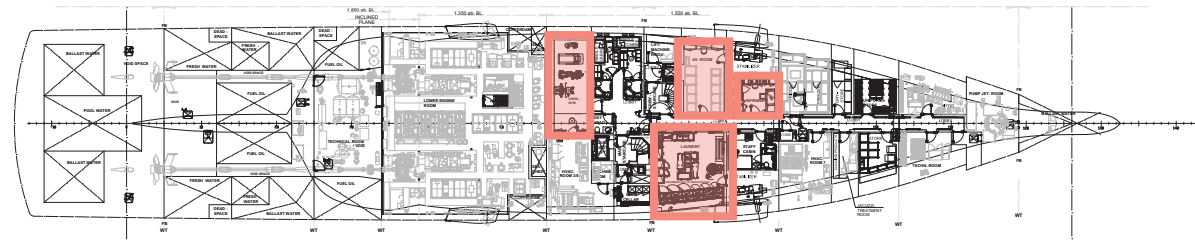

CREW GYM



LAUNDRY



AV ROOM



INFIRMARY



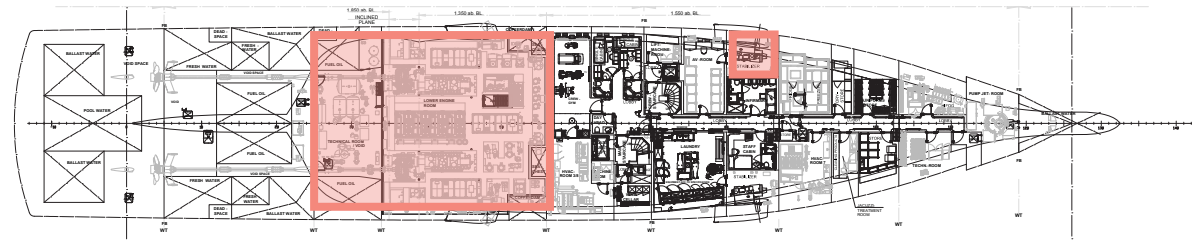





[AmadeaAuction.com](https://AmadeaAuction.com)